



Technical catalog manifolds for fan coils

GV STAMPERIE S.p.A.

Via Europa, 9 - 25040 Monticelli Brusati (Brescia) - Italy - Phone +39 030 6850393 - Fax +39 030 653633
P. IVA e Cod. Fiscale 03097470177 - Registro Imprese di Brescia n. 03097470177 - R.E.A. BS 323773
Cap. sociale: Euro 1.400.000,00 iv. - sales@gvs.eu - www.gvs.eu

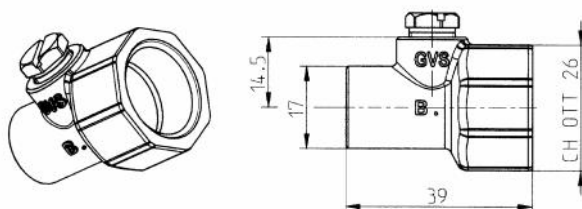

GVS 3300 : manifold 1/2" for copper pipe Ø9.52**GVS 3300.01**

Assembled manifold 1/2" bleeding screw hexagonal 1/8"

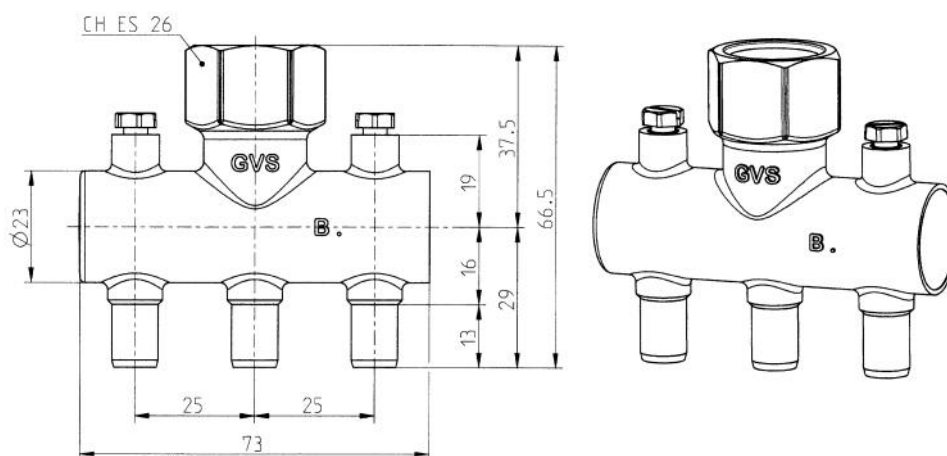
GVS 3301 : manifold 1/2" geometry 25x25 **HEAVY****GVS 3301.01**

Assembled manifold 1/2" 3 branches pitch 25 bleeding screw M6

GVS 3301.02

Assembled manifold 1/2" 2 branches pitch 50 bleeding screw M6

GVS 3301.03

Assembled manifold 1/2" 2 branches pitch 25 bleeding screw M6

GVS 3301 : manifold 1/2" geometry 25x25 **LIGHT**
with seat for O-ring

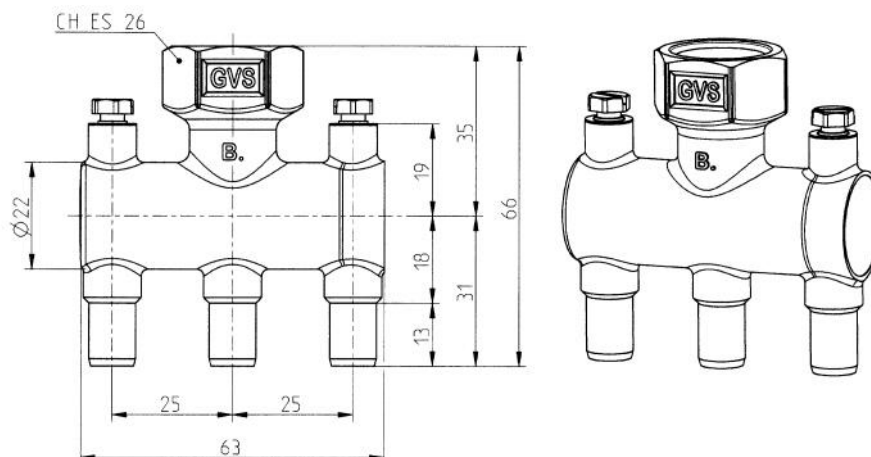

GVS 3301.11	Assembled manifold 1/2" 3 branches pitch 25 bleeding screw M6
GVS 3301.12	Assembled manifold 1/2" 2 branches pitch 50 bleeding screw M6
GVS 3301.13	Assembled manifold 1/2" 2 branches pitch 25 bleeding screw M6

GVS 3301 : manifold 1/2" geometry 25x25 **LIGHT**
with seat for O-ring and tapered branches

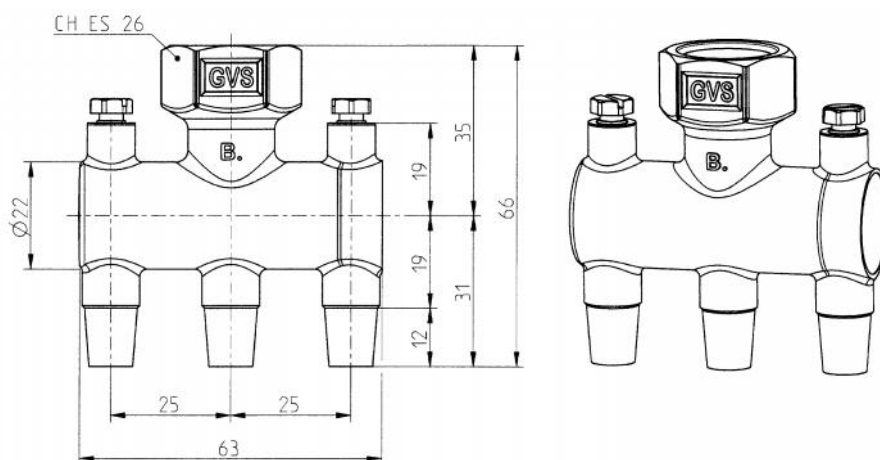

GVS 3301.14	Assembled manifold 1/2" 3 branches pitch 25 bleeding screw M6
GVS 3301.15	Assembled manifold 1/2" 2 branches pitch 50 bleeding screw M6
GVS 3301.16	Assembled manifold 1/2" 2 branches pitch 25 bleeding screw M6

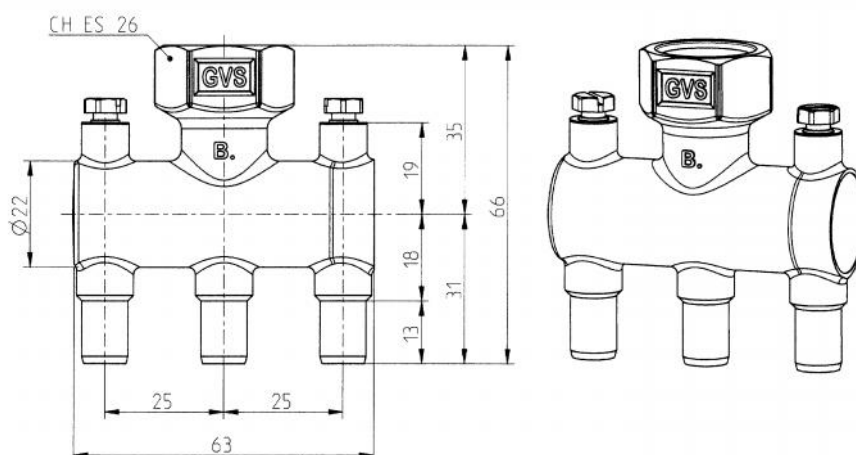
GVS 3301 : manifold 1/2" geometry 25x25 LIGHT**GVS 3301.21**

Assembled manifold 1/2" 3 branches pitch 25 bleeding screw M6

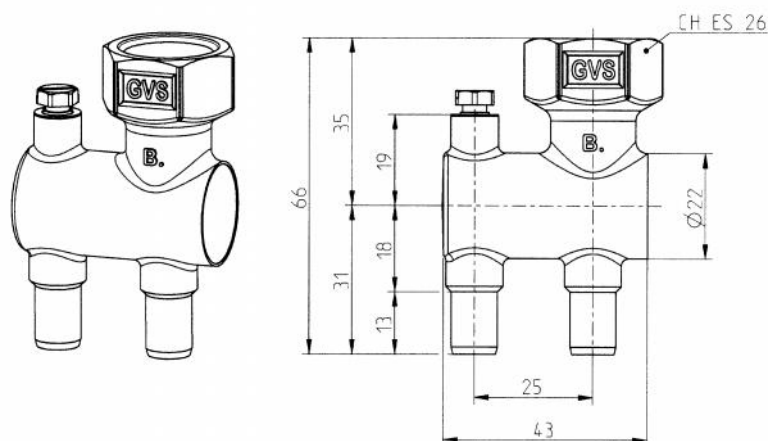
GVS 3301 : manifold 1/2" geometry 25x25 LIGHT**GVS 3301.31**

Assembled manifold 1/2" 2 branches pitch 25 bleeding screw M6

GVS 3302 : manifold 1/2" geometry 25x25
with seat for O-ring

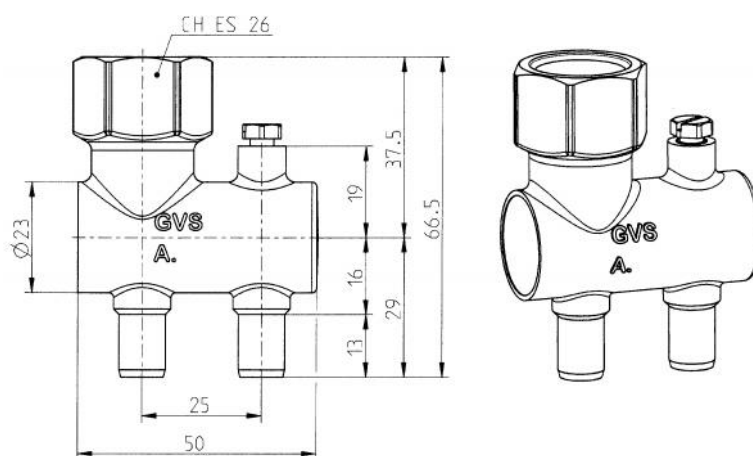

GVS 3302.11

Assembled manifold 1/2" 2 branches pitch 25 bleeding screw M6

GVS 3303 : manifold 1/2" for copper pipe Ø9.52

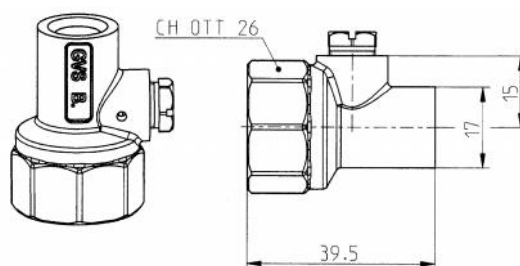

GVS 3303.01

Assembled manifold 1/2" bleeding screw hexagonal 1/8"

GVS 3303.02

Assembled manifold 1/2" bleeding screw hexagonal 1/8" with seat for O-ring

GVS 3304 : single branch manifold 1/2" **MALE**
with seat for O-ring

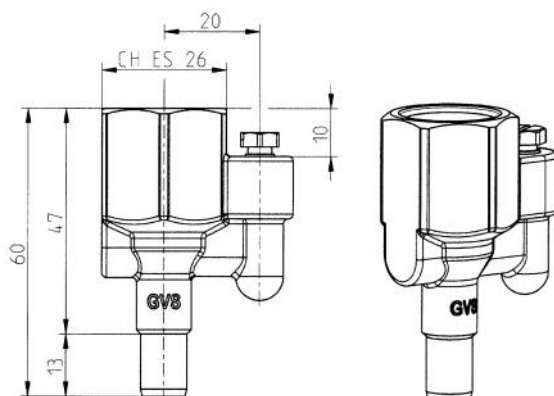

GVS 3304.01	Assembled manifold 1/2" 1 branch bleeding screw M6
GVS 3304.02	Assembled manifold 1/2" 1 branch with by-pass bleeding screw M6
GVS 3304.03	Assembled manifold 1/2" 1 tapered branch bleeding screw M6

GVS 3305 : manifold 1/2" geometry 21.65x25
with seat for O-ring

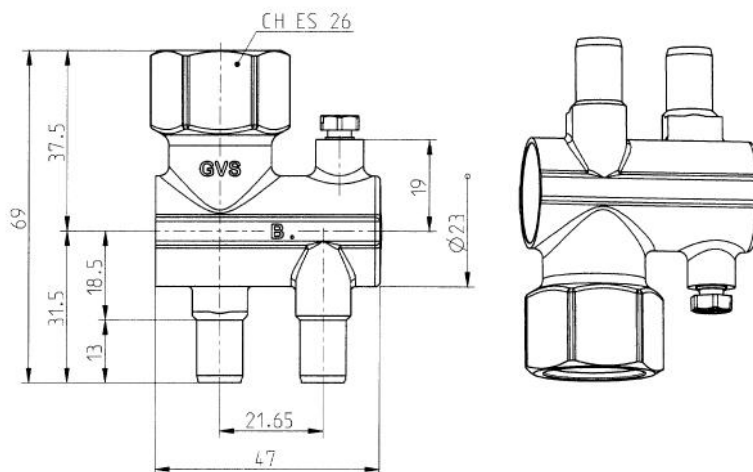

GVS 3305.11	Assembled manifold 1/2" 2 branches pitch 21.65 RIGHT bleeding screw M6
--------------------	--

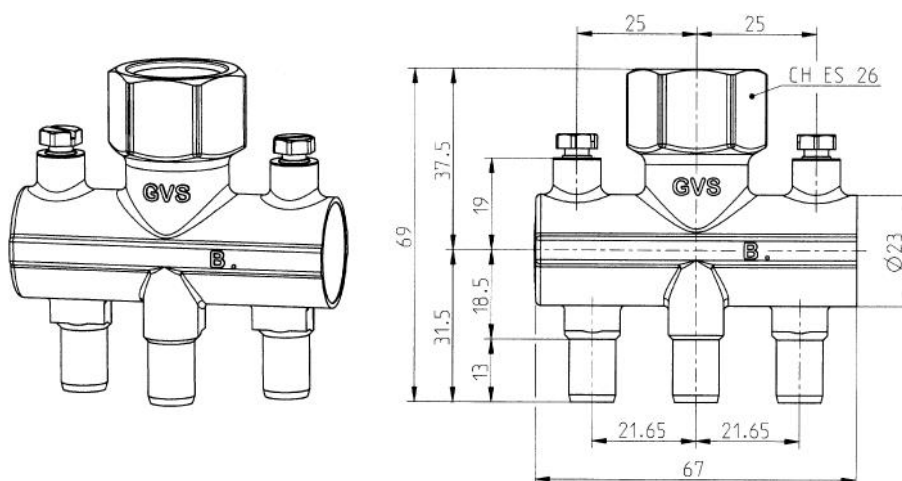
GVS 3306 : manifold 1/2" geometry 21.65x25 HEAVY

GVS 3306.01	Assembled manifold 1/2" 3 branches pitch 21.65 bleeding screw M6
GVS 3306.02	Assembled manifold 1/2" 2 branches pitch 43.3 bleeding screw M6
GVS 3306.03	Assembled manifold 1/2" 2 branches pitch 21.65 RIGHT bleeding screw M6

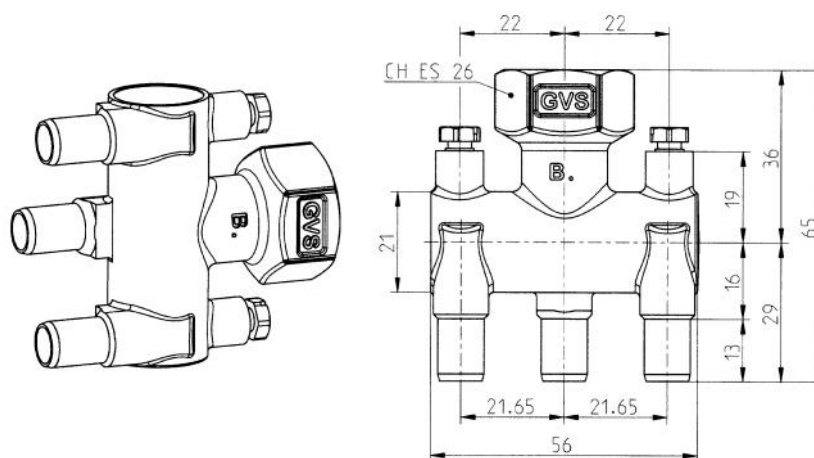
GVS 3306 : manifold 1/2" geometry 21.65x25 LIGHT with seat for O-ring

GVS 3306.11	Assembled manifold 1/2" 3 branches pitch 21.65 bleeding screw M6
GVS 3306.12	Assembled manifold 1/2" 2 branches pitch 43.3 bleeding screw M6
GVS 3306.13	Assembled manifold 1/2" 2 branches pitch 21.65 LEFT bleeding screw M6
GVS 3306.14	Assembled manifold 1/2" 2 branches pitch 21.65 RIGHT bleeding screw M6

GVS 3307 : manifold 1/2" **FEMALE**
for circular batteries

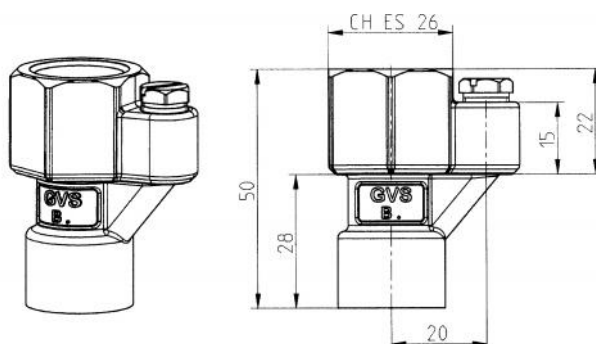

GVS 3307.01

Assembled manifold 1/2" for copper pipe Ø18 bleeding screw hexagonal 1/8"

GVS 3307.02

Assembled manifold 1/2" for copper pipe Ø12 bleeding screw hexagonal 1/8"

GVS 3308 : manifold 1/2" geometry 19x25
with seat for O-ring

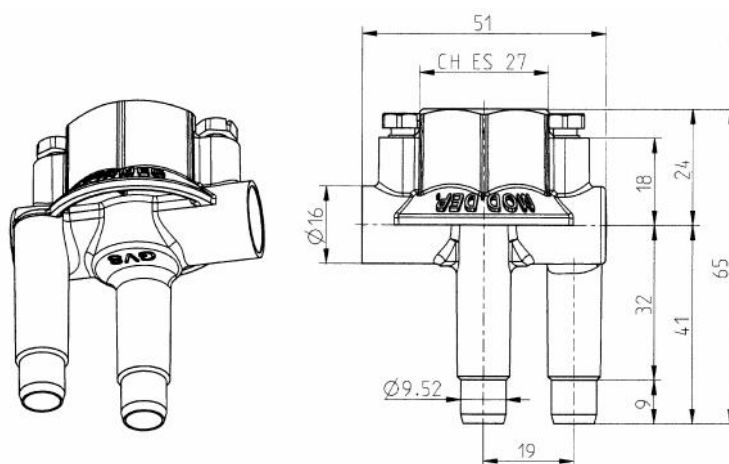

GVS 3308.01

Assembled manifold 1/2" 2 branches pitch 19 bleeding screw M6

GVS 3309 : manifold 3/4" geometry 19x25
with seat for O-ring

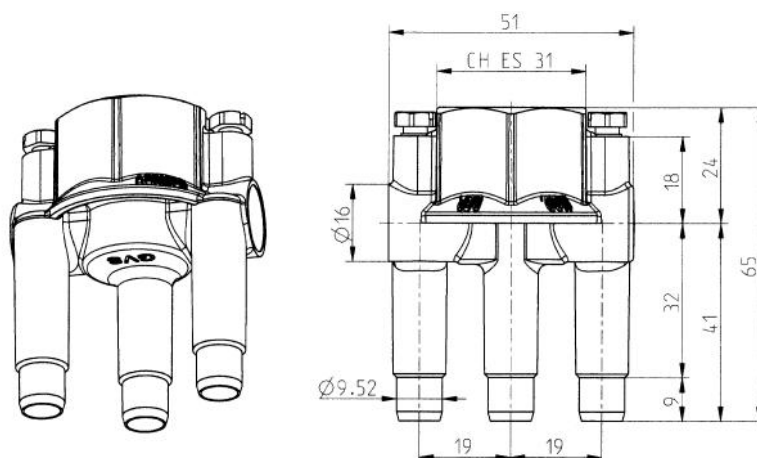

GVS 3309.01

Assembled manifold 3/4" 3 branches pitch 19 bleeding screw M6

GVS 3310 : manifold 1/2" geometry 21.65x25 **HEAVY**

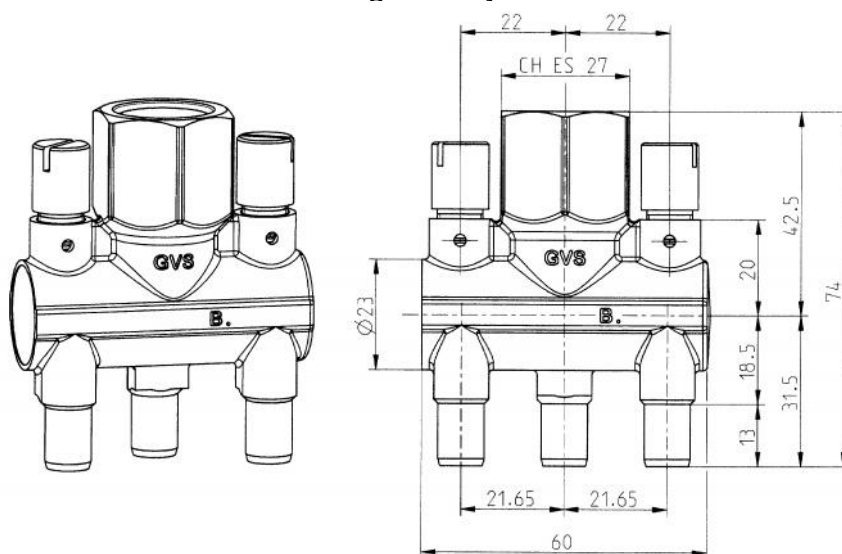

GVS 3310.01

Assembled manifold 1/2" 3 branches pitch 21.65 bleeding screw cylindrical 1/8"

GVS 3310.02

Assembled manifold 1/2" 2 branches pitch 43.3 bleeding screw cylindrical 1/8"

GVS 3310.03

Assembled manifold 1/2" 2 branches pitch 21.65 LEFT bleeding screw cylindrical 1/8"

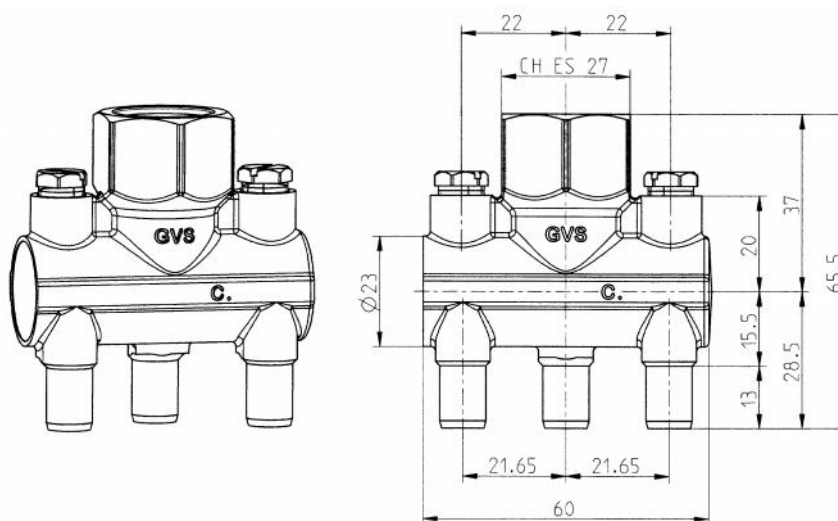
GVS 3310 : manifold 1/2" geometry 21.65x25 NORMAL

GVS 3310.04	Assembled manifold 1/2" 3 branches pitch 21.65 bleeding screw hexagonal 1/8"
GVS 3310.05	Assembled manifold 1/2" 2 branches pitch 43.3 bleeding screw hexagonal 1/8"
GVS 3310.06	Assembled manifold 1/2" 2 branches pitch 21.65 LEFT bleeding screw hexagonal 1/8"

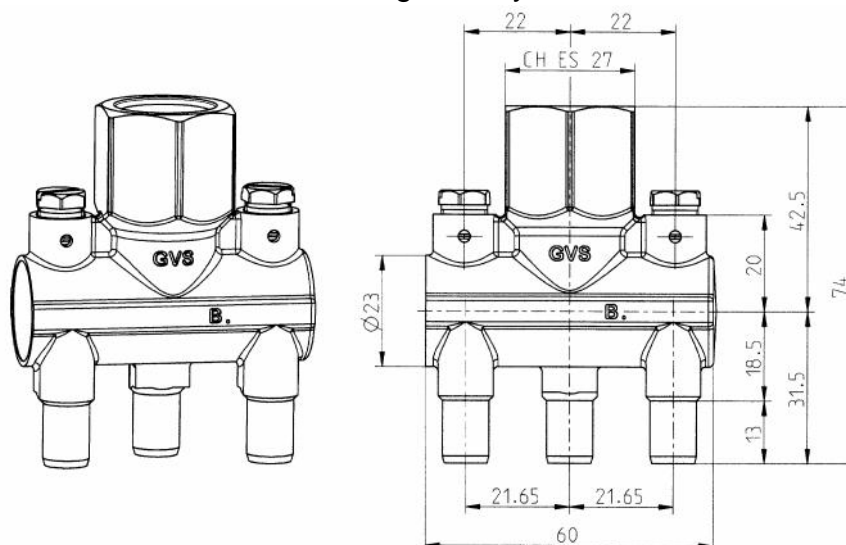
GVS 3310 : manifold 1/2" geometry 21.65x25 HEAVY

GVS 3310.07	Assembled manifold 1/2" 3 branches pitch 21.65 bleeding screw hexagonal 1/8"
GVS 3310.08	Assembled manifold 1/2" 2 branches pitch 43.3 bleeding screw hexagonal 1/8"
GVS 3310.09	Assembled manifold 1/2" 2 branches pitch 21.65 LEFT bleeding screw hexagonal 1/8"

GVS 3310 : manifold 1/2" geometry 21.65x25 **LIGHT**
with seat for O-ring

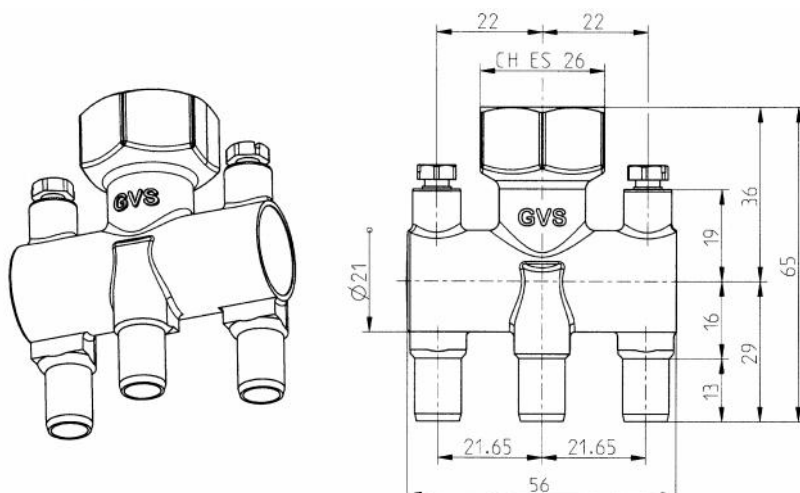

GVS 3310.11	Assembled manifold 1/2" 3 branches pitch 21.65 bleeding screw M6
GVS 3310.12	Assembled manifold 1/2" 2 branches pitch 43.3 bleeding screw M6
GVS 3310.13	Assembled manifold 1/2" 2 branches pitch 21.65 LEFT bleeding screw M6

GVS 3310 : manifold 1/2" geometry 21.65x25 **LIGHT**

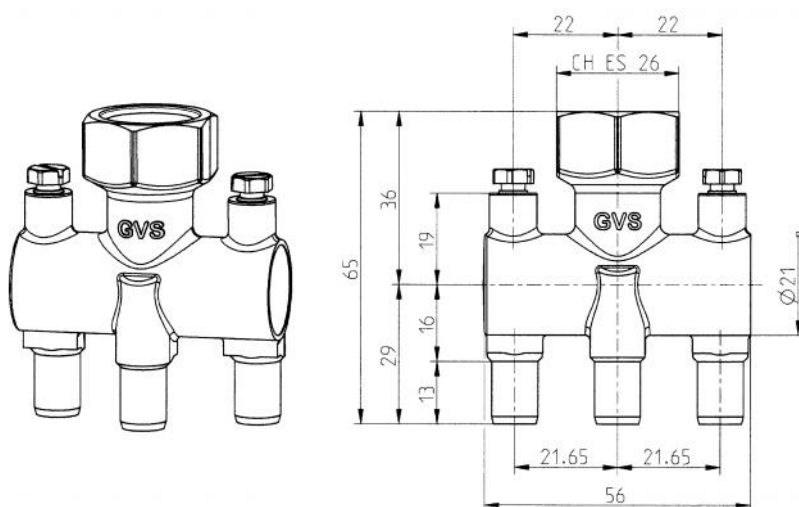

GVS 3310.21	Assembled manifold 1/2" 3 branches pitch 21.65 bleeding screw M6
--------------------	--

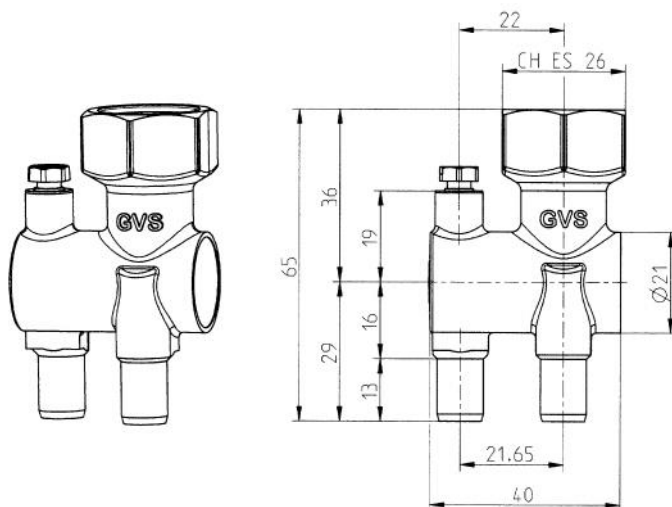
GVS 3310 : manifold 1/2" geometry 21.65x25 **LIGHT****GVS 3310.31**

Assembled manifold 1/2" 2 branches pitch 21.65 RIGHT bleeding screw M6

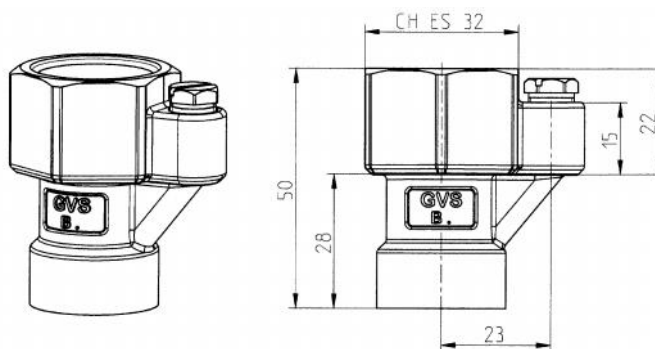
GVS 3311 : manifold 3/4" **FEMALE**
for circular batteries**GVS 3311.01**

Assembled manifold 3/4" for copper tube Ø22 bleeding screw hexagonal 1/8"

GVS 3312 : single branch manifold 1/2" MALE

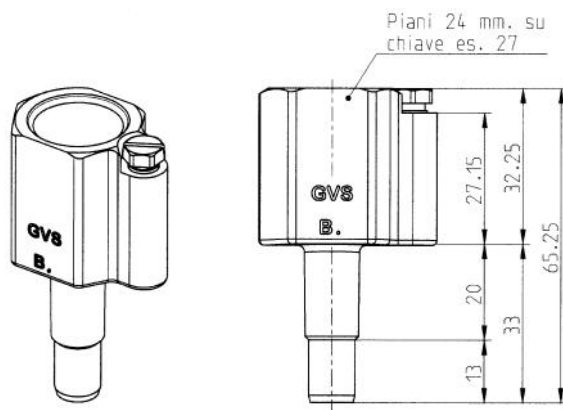

GVS 3312.01	Assembled manifold 1/2" 1 branch bleeding screw M6
GVS 3312.02	Assembled manifold 1/2" 1 branch with by-pass bleeding screw M6
GVS 3312.03	Assembled manifold 1/2" 1 branch bleeding screw M6 with seat for O-ring

GVS 3313 : manifold 1/2" geometry 21.65/25x25

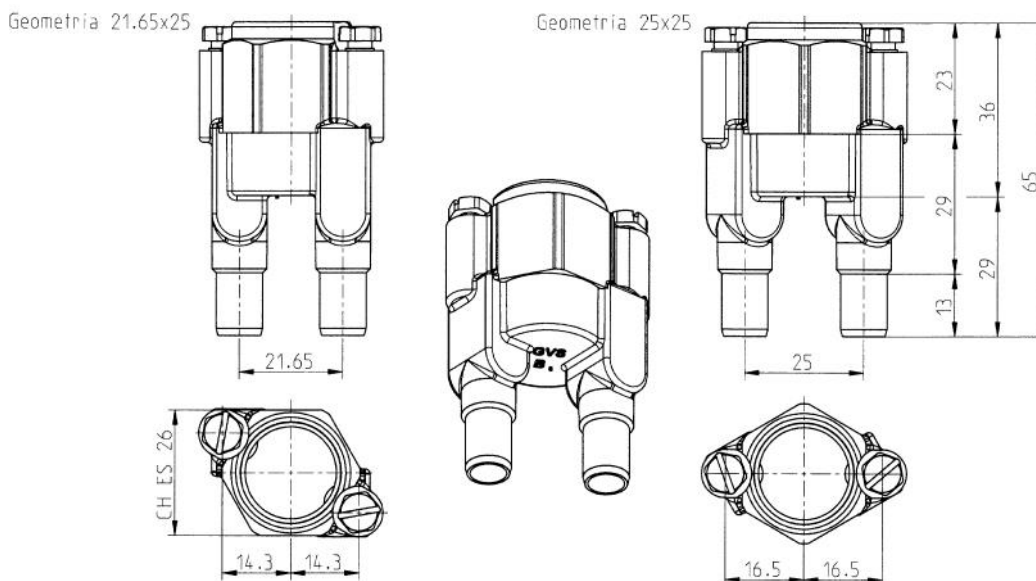

GVS 3313.01	Assembled manifold 1/2" 2 branches pitch 21.65/25 bleeding screw M6
--------------------	---

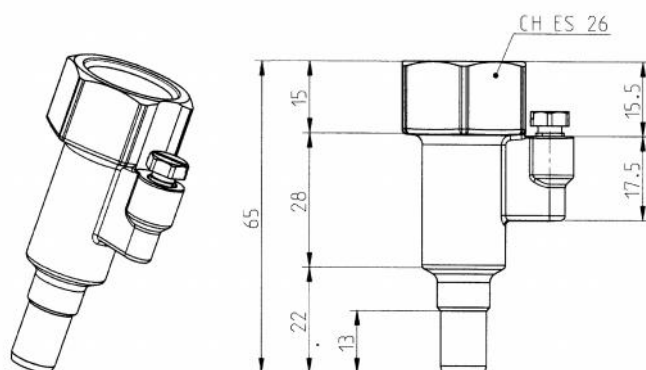

Assembled manifold 1/2" 1 branch bleeding screw M6

GVS 3315 : manifold 1/2" geometry 25x25
with seat for O-ring

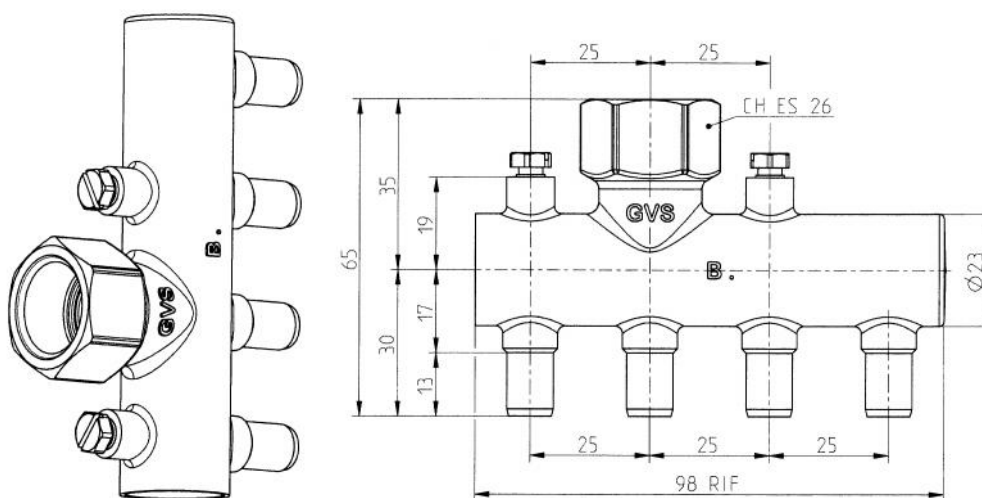

Assembled manifold 1/2" 4 branches pitch 25 bleeding screw M6

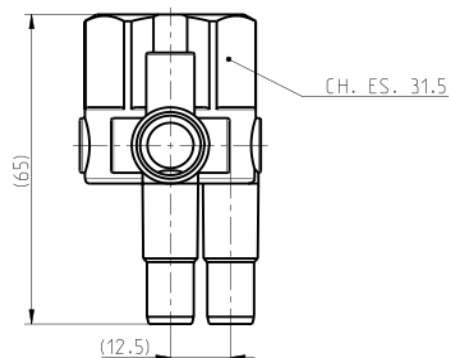
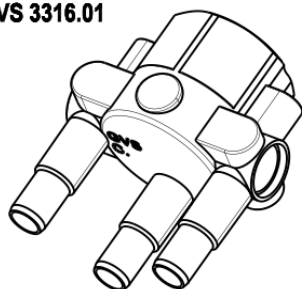
GVS 3316 : manifold 3/4" geometry 21.65x25 with seat for O-ring**GVS 3316.01**

GVS 3316.01	Assembled manifold 3/4" 3 branches pitch 21.65 bleeding screw M6
GVS 3316.02	Assembled manifold 3/4" 2 branches pitch 43.3 bleeding screw M6
GVS 3316.03	Assembled manifold 3/4" 2 branches pitch 21.65 LEFT bleeding screw M6
GVS 3316.04	Assembled manifold 3/4" 1 branche bleeding screw M6
GVS 3316.05	Assembled manifold 3/4" 1 branche LEFT bleeding screw M6

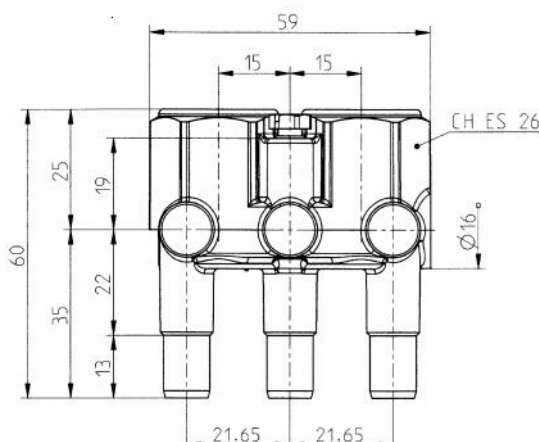
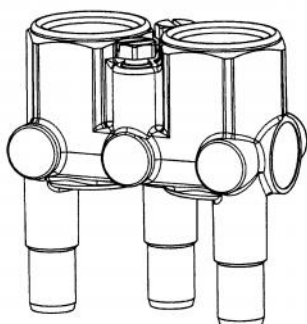
GVS 3320 : manifold 1/2" geometry 21.65x25 **double supply**

GVS 3320.01	Assembled manifold 1/2" 2+1 branches pitch 21.65 bleeding screw M6
GVS 3320.02	Assembled manifold 1/2" 2+1 branches pitch 21.65 bleeding screw M6 +3 lower circuits
GVS 3320.03	Assembled manifold 1/2" 2+1 branches pitch 21.65 bleeding screw M6 +3 upper circuits

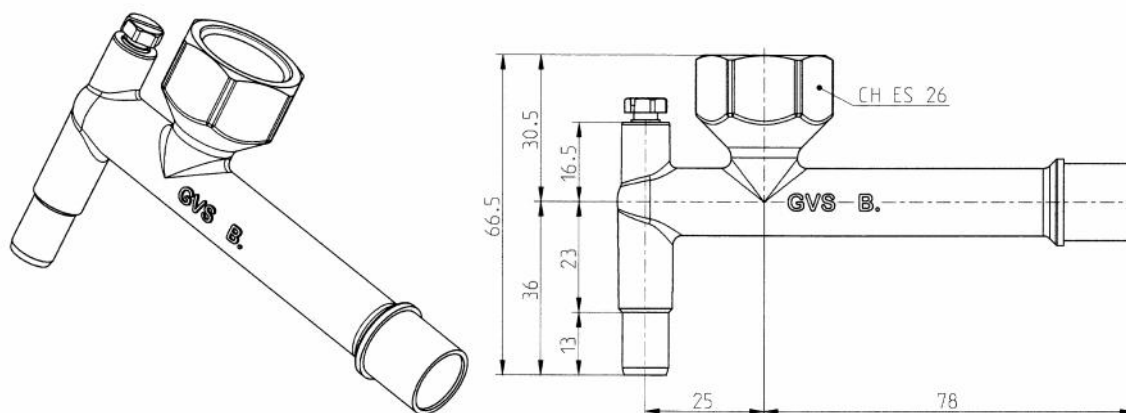
GVS 3321 : single branch manifold 1/2" 90° L109**GVS 3321.01**

Assembled manifold 1 branch 1/2" bleeding screw M6

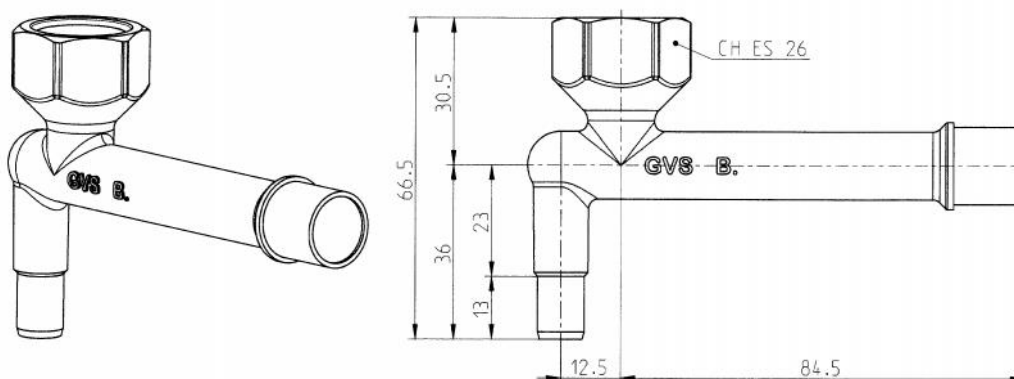
GVS 3322 : single branche manifold 1/2" 90° L104**GVS 3322.01**

Assembled manifold 1 branch 1/2"

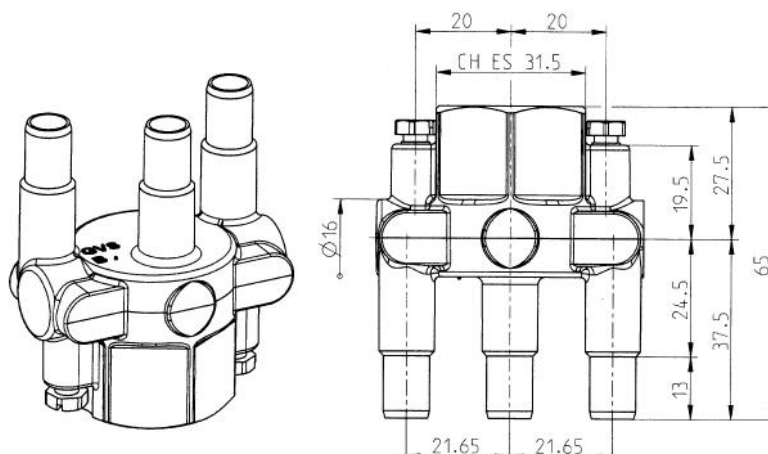
GVS 3323 : manifold 3/4" geometry 21.65x25

GVS 3323.01	Assembled manifold 3/4" 3 branches pitch 21.65 bleeding screw M6
GVS 3323.02	Assembled manifold 3/4" 2 branches pitch 43.3 bleeding screw M6
GVS 3323.03	Assembled manifold 3/4" 2 branches pitch 21.65 LEFT bleeding screw M6
GVS 3323.04M	Assembled manifold 3/4" 1 branche bleeding screw M6

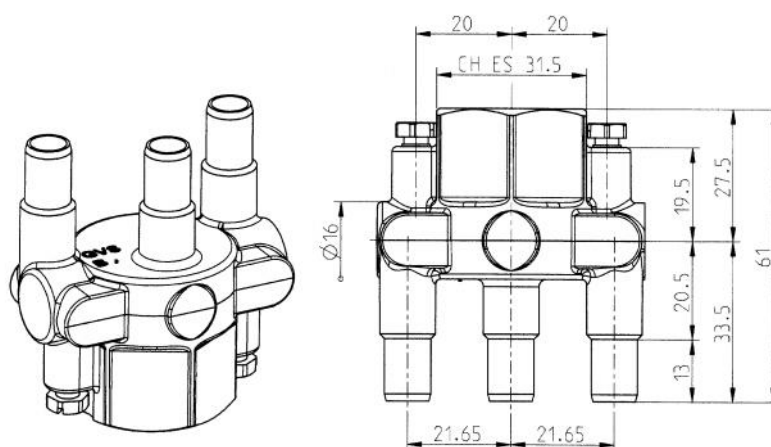
GVS 3323 : manifold 3/4" geometry 21.65x25 **SHORT**

GVS 3323.04	Assembled manifold 3/4" 3 branches pitch 21.65 bleeding screw M6
--------------------	--

GV STAMPERIE S.p.A.

Via Europa, 9 - 25040 Monticelli Brusati (Brescia) - Italy - Phone +39 030 6850393 - Fax +39 030 653633
P. IVA e Cod. Fiscale 03097470177 - Registro Imprese di Brescia n. 03097470177 - R.E.A. BS 323773
Cap. sociale: Euro 1.400.000,00 iv. - sales@gvs.eu - www.gvs.eu

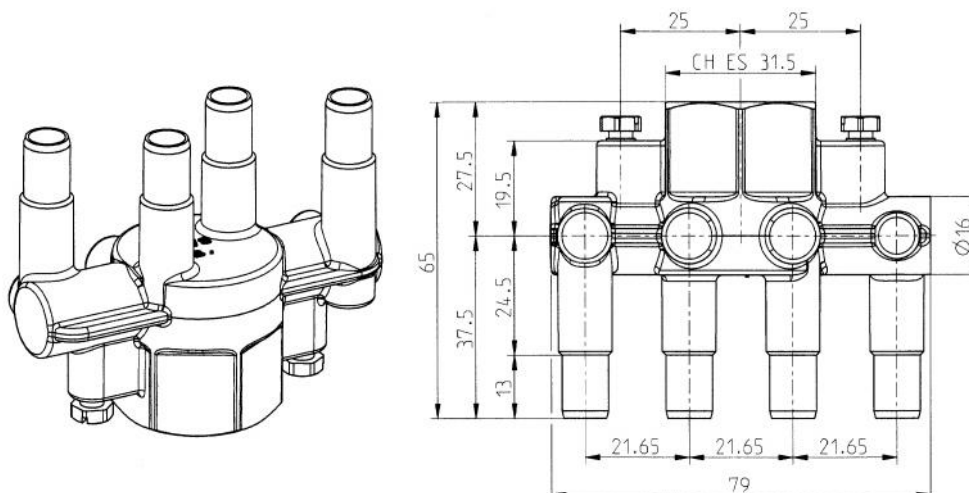

GVS 3324 : manifold 3/4" geometry 21.65x25

GVS 3324.01	Assembled manifold 3/4" 4 branches pitch 21.65 bleeding screw M6
--------------------	--

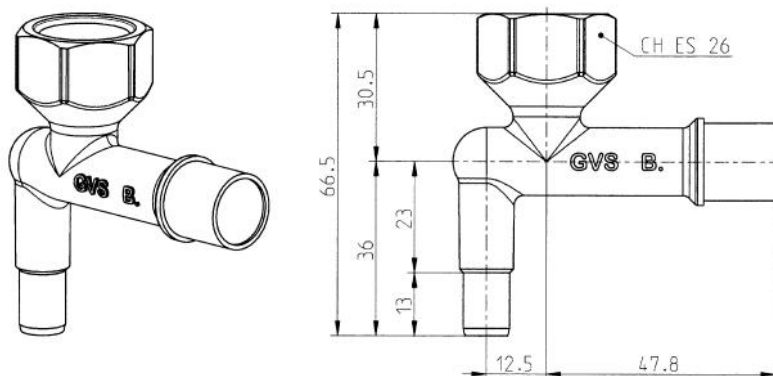
GVS 3325 : single branch manifold 1/2" 90° L67.5

GVS 3325.01	Assembled manifold 1 branch 1/2"
--------------------	----------------------------------

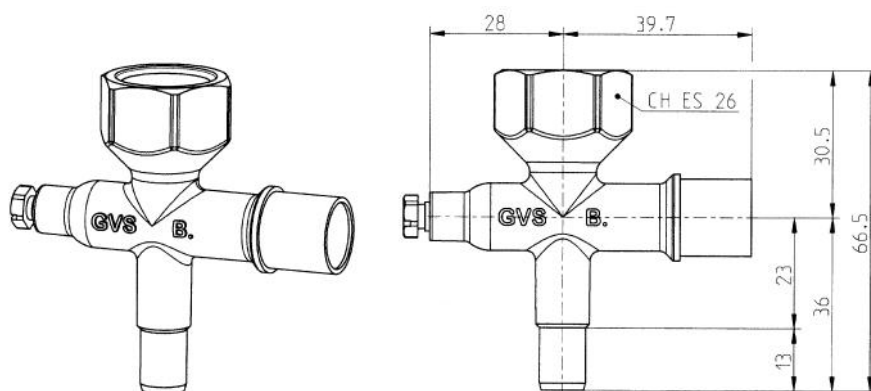
GVS 3326 : single branch manifold 1/2" 90° L60**GVS 3326.01**

Assembled manifold 1 branch 1/2" bleeding screw M6

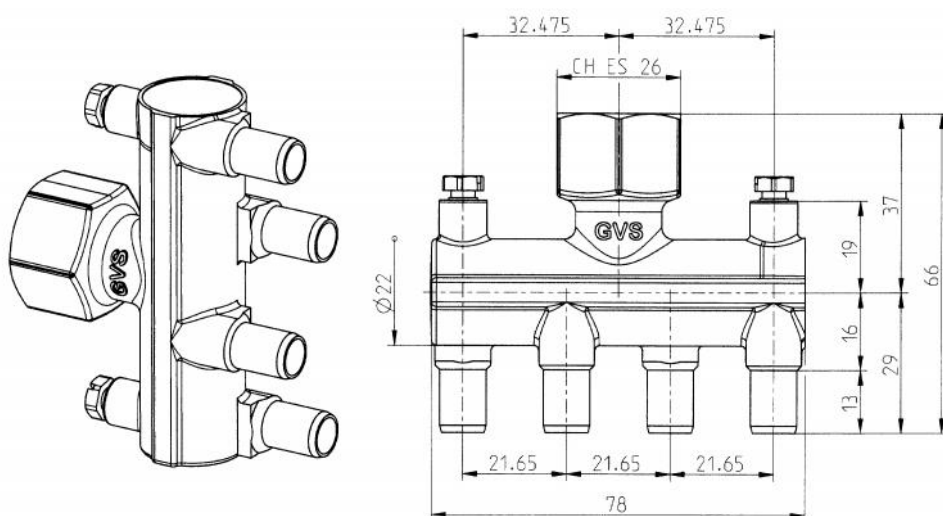
GVS 3329 : manifold 1/2" geometry 21.65x25**GVS 3329.21**

Assembled manifold 1/2" 4 branches pitch 21.65 bleeding screw M6

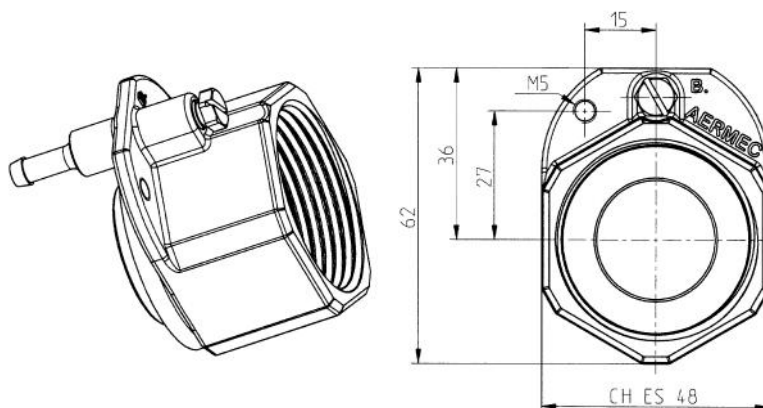
GVS 3330 : water connection 1"1/4**GVS 3330.02**

Water connection 1"1/4 bleeding screw M6

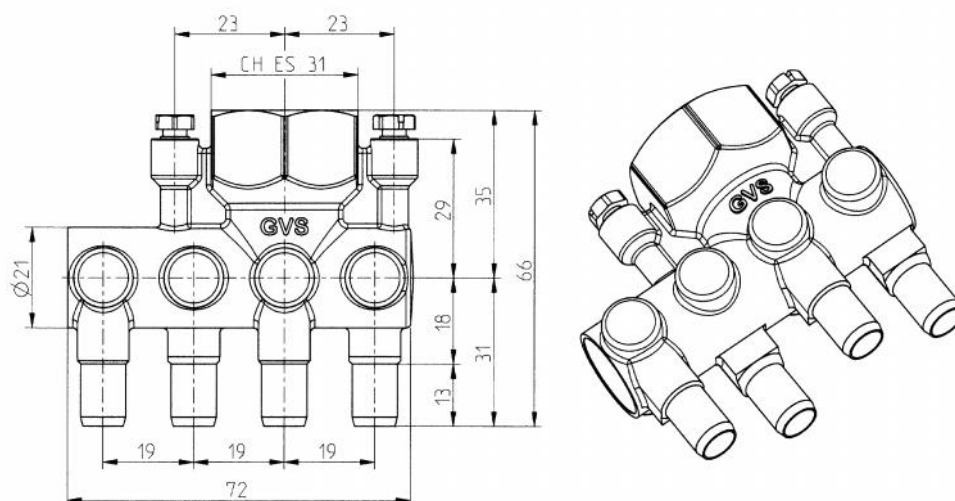
GVS 3331 : manifold 3/4" geometry 19x25
with seat for O-ring**GVS 3331.01**

Assembled manifold 3/4" 4 branches pitch 19 bleeding screw M6

GVS 3331.02

Assembled manifold 3/4" 4 branches pitch 19 upper bleeding screw M6

GVS 3331.03

Assembled manifold 3/4" 4 branches pitch 19 lower bleeding screw M6

GVS 3332 : manifold 3/4" geometry 19x25 with seat for O-ring

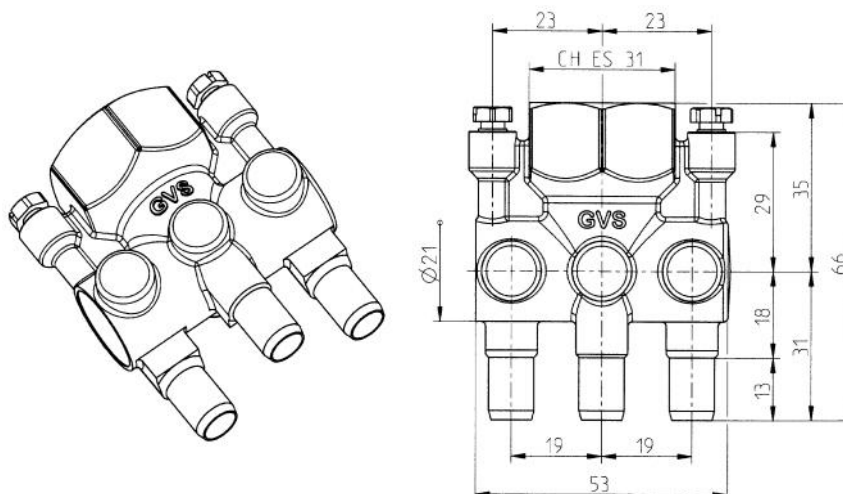

GVS 3332.01	Assembled manifold 3/4" 3 branches pitch 19 bleeding screw M6
GVS 3332.02	Assembled manifold 3/4" 3 branches pitch 19 upper bleeding screw M6
GVS 3332.03	Assembled manifold 3/4" 3 branches pitch 19 lower bleeding screw M6

GVS 3333 : manifold 3/4" geometry 21.65x25

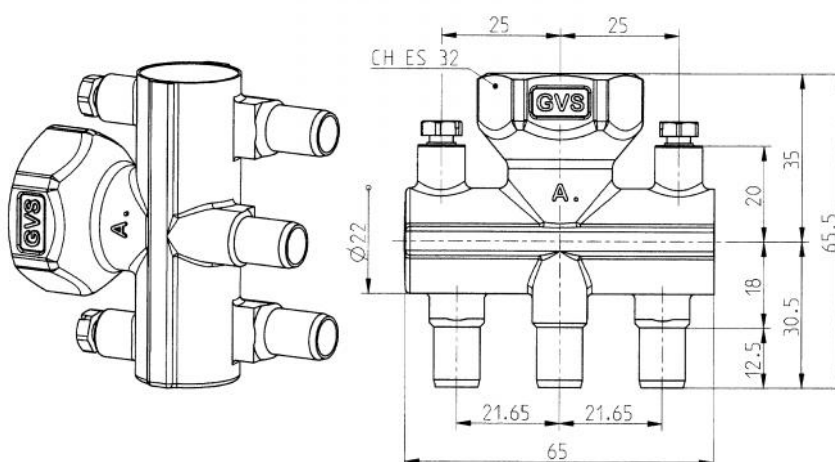

GVS 3333.01	Assembled manifold 3/4" 3 branches pitch 21.65 bleeding screw M6
GVS 3333.02	Assembled manifold 3/4" 2 branches pitch 43.3 bleeding screw M6
GVS 3333.03	Assembled manifold 3/4" 2 branches pitch 21.65 LEFT bleeding screw M6
GVS 3333.04	Assembled manifold 3/4" 2 branches pitch 21.65 RIGHT bleeding screw M6

GVS 3333 : manifold 3/4" geometry 21.65x25
with seat for O-ring

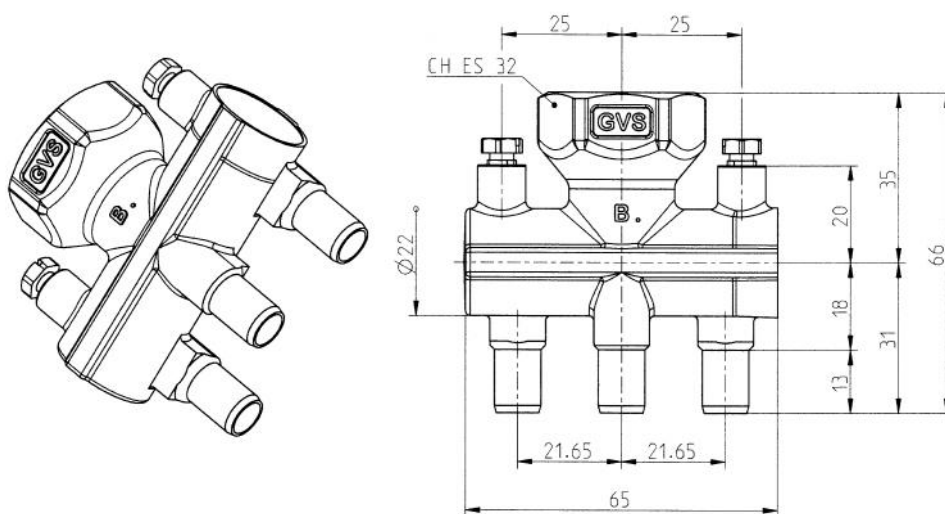

GVS 3333.11	Assembled manifold 3/4" 3 branches pitch 21.65 bleeding screw M6
--------------------	--

GVS 3334 : manifold 3/4" geometry 25x25

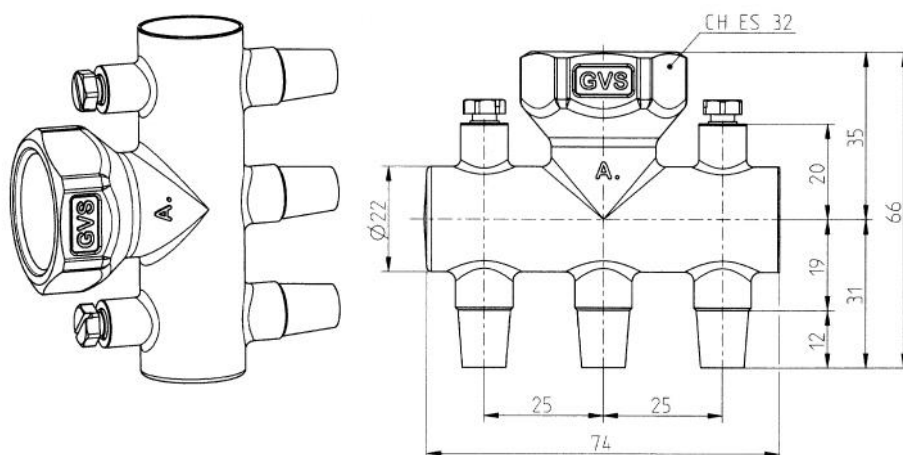

GVS 3334.01	Assembled manifold 3/4" 3 tapered branches pitch 25 bleeding screw M6
--------------------	---

GVS 3334.02	Assembled manifold 3/4" 3 cylindrical branches pitch 25 bleeding screw M6
--------------------	---